

REV	DESCRIPTION	DATE	BY
A	NEW DRAWING	09/11/02	H.N.
B	ADDED SMT NOTES	12/08/03	H.N.
C	ADDED BOM & BOTTOM VIEW	09/09/10	JAG
D	ADDED NOTE 4 AND PAGE 2	04/15/13	JAG

F6690
DOD 36690

TOP VIEW

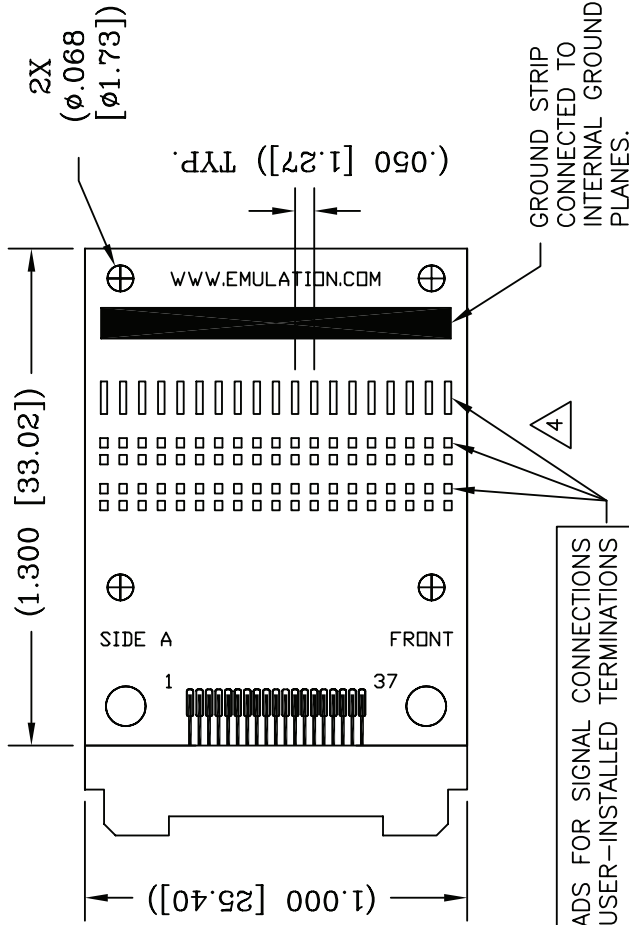

BOTTOM VIEW

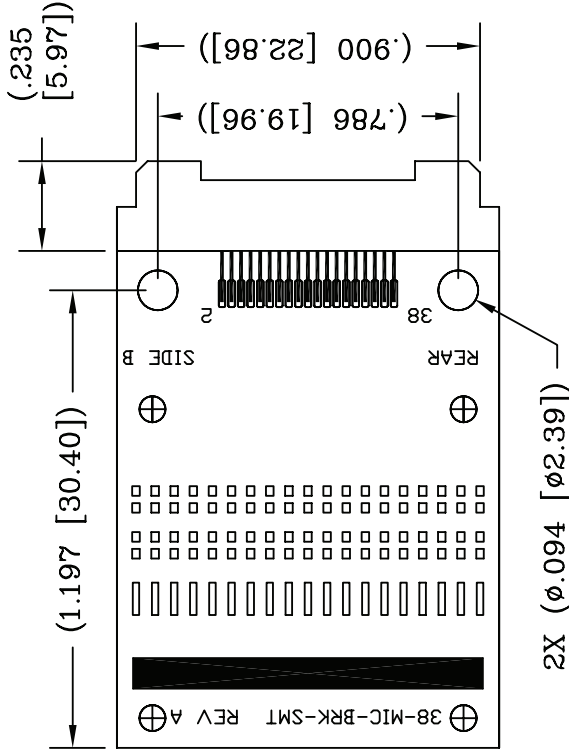

- NOTES:
- PINOUT MATCHES AGILENT (HP) STANDARD.
 - THIS PART MATES WITH ET ITEM # CONMICFEM38SMT (DRAWING # F1416)
 - MATES WITH TYCO PART NUMBERS:
2-767004-2, 767054-1, 767044-1
 - ADAPTER BRINGS DIGITAL SIGNALS OUT TO ACCESSIBLE PADS. TERMINATIONS ARE OPTIONAL (NONE BY DEFAULT).

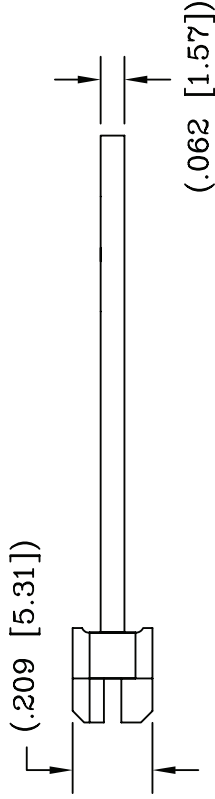

NO.	ITEM	DESCRIPTION	QTY.
1	38-MIC-BRK-SMT	BASE BOARD	1
2	CONMIC38MALEDGE	SOLDER TO EDGE OF #1	1
3	R-00HM-0402-SMT	OPTIONAL 4	A/R

UNLESS OTHERWISE SPECIFIED:
DIMENSIONS ARE IN INCHES [MM]

TOLERANCES ARE:

DECIMALS:
XX .±0.010 ANGLES ±10°
XXX .±0.005
[X] .±0.25 FRACTIONS ±1/64
[XXX] ±0.13
[XXX] ±0.013

ALL DIMENSIONS ARE IN INCHES [MM] UNLESS OTHERWISE SPECIFIED

Emulation Technology, Inc.
— VLSI and SMT ADAPTERS and ACCESSORIES —

759 FLYNN ROAD
CAMARILLO, CA 93012
TEL: (805) 383-8480
FAX: (805) 383-8484

SHEET: 1 OF 1
DATE: 12/08/03
REVISION: D

CHECKED: Perry Munroe
DRAWN: Huy Nguyen

ITEM: MIC-38-SMTPADS
DESCRIPTION: MIC-38-SMTPADS

ASSEMBLY DRAWING

Scale 2:1 DO NOT SCALE DRAWING

PIN MAP
(WIRED 1 TO 1)

SEE DETAIL A

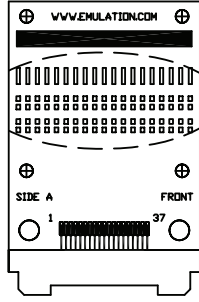

SEE DETAIL B

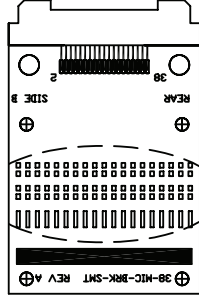

<input type="checkbox"/> R1A	<input type="checkbox"/>	<input type="checkbox"/> R1B	<input type="checkbox"/>	<input type="checkbox"/> PAD1
<input type="checkbox"/> R3A	<input type="checkbox"/>	<input type="checkbox"/> R3B	<input type="checkbox"/>	<input type="checkbox"/> PAD3
<input type="checkbox"/> R5A	<input type="checkbox"/>	<input type="checkbox"/> R5B	<input type="checkbox"/>	<input type="checkbox"/> PAD5
<input type="checkbox"/> R7A	<input type="checkbox"/>	<input type="checkbox"/> R7B	<input type="checkbox"/>	<input type="checkbox"/> PAD7
<input type="checkbox"/> R9A	<input type="checkbox"/>	<input type="checkbox"/> R9B	<input type="checkbox"/>	<input type="checkbox"/> PAD9
<input type="checkbox"/> R11A	<input type="checkbox"/>	<input type="checkbox"/> R11B	<input type="checkbox"/>	<input type="checkbox"/> PAD11
<input type="checkbox"/> R13A	<input type="checkbox"/>	<input type="checkbox"/> R13B	<input type="checkbox"/>	<input type="checkbox"/> PAD13
<input type="checkbox"/> R15A	<input type="checkbox"/>	<input type="checkbox"/> R15B	<input type="checkbox"/>	<input type="checkbox"/> PAD15
<input type="checkbox"/> R17A	<input type="checkbox"/>	<input type="checkbox"/> R17B	<input type="checkbox"/>	<input type="checkbox"/> PAD17
<input type="checkbox"/> R19A	<input type="checkbox"/>	<input type="checkbox"/> R19B	<input type="checkbox"/>	<input type="checkbox"/> PAD19
<input type="checkbox"/> R21A	<input type="checkbox"/>	<input type="checkbox"/> R21B	<input type="checkbox"/>	<input type="checkbox"/> PAD21
<input type="checkbox"/> R23A	<input type="checkbox"/>	<input type="checkbox"/> R23B	<input type="checkbox"/>	<input type="checkbox"/> PAD23
<input type="checkbox"/> R25A	<input type="checkbox"/>	<input type="checkbox"/> R25B	<input type="checkbox"/>	<input type="checkbox"/> PAD25
<input type="checkbox"/> R27A	<input type="checkbox"/>	<input type="checkbox"/> R27B	<input type="checkbox"/>	<input type="checkbox"/> PAD27
<input type="checkbox"/> R29A	<input type="checkbox"/>	<input type="checkbox"/> R29B	<input type="checkbox"/>	<input type="checkbox"/> PAD29
<input type="checkbox"/> R31A	<input type="checkbox"/>	<input type="checkbox"/> R31B	<input type="checkbox"/>	<input type="checkbox"/> PAD31
<input type="checkbox"/> R33A	<input type="checkbox"/>	<input type="checkbox"/> R33B	<input type="checkbox"/>	<input type="checkbox"/> PAD33
<input type="checkbox"/> R35A	<input type="checkbox"/>	<input type="checkbox"/> R35B	<input type="checkbox"/>	<input type="checkbox"/> PAD35
<input type="checkbox"/> R37A	<input type="checkbox"/>	<input type="checkbox"/> R37B	<input type="checkbox"/>	<input type="checkbox"/> PAD37

DETAIL A

<input type="checkbox"/> PAD2	<input type="checkbox"/>	<input type="checkbox"/> R2B	<input type="checkbox"/>	<input type="checkbox"/> R2A
<input type="checkbox"/> PAD4	<input type="checkbox"/>	<input type="checkbox"/> R4B	<input type="checkbox"/>	<input type="checkbox"/> R4A
<input type="checkbox"/> PAD6	<input type="checkbox"/>	<input type="checkbox"/> R6B	<input type="checkbox"/>	<input type="checkbox"/> R6A
<input type="checkbox"/> PAD8	<input type="checkbox"/>	<input type="checkbox"/> R8B	<input type="checkbox"/>	<input type="checkbox"/> R8A
<input type="checkbox"/> PAD10	<input type="checkbox"/>	<input type="checkbox"/> R10B	<input type="checkbox"/>	<input type="checkbox"/> R10A
<input type="checkbox"/> PAD12	<input type="checkbox"/>	<input type="checkbox"/> R12B	<input type="checkbox"/>	<input type="checkbox"/> R12A
<input type="checkbox"/> PAD14	<input type="checkbox"/>	<input type="checkbox"/> R14B	<input type="checkbox"/>	<input type="checkbox"/> R14A
<input type="checkbox"/> PAD16	<input type="checkbox"/>	<input type="checkbox"/> R16B	<input type="checkbox"/>	<input type="checkbox"/> R16A
<input type="checkbox"/> PAD18	<input type="checkbox"/>	<input type="checkbox"/> R18B	<input type="checkbox"/>	<input type="checkbox"/> R18A
<input type="checkbox"/> PAD20	<input type="checkbox"/>	<input type="checkbox"/> R20B	<input type="checkbox"/>	<input type="checkbox"/> R20A
<input type="checkbox"/> PAD22	<input type="checkbox"/>	<input type="checkbox"/> R22B	<input type="checkbox"/>	<input type="checkbox"/> R22A
<input type="checkbox"/> PAD24	<input type="checkbox"/>	<input type="checkbox"/> R24B	<input type="checkbox"/>	<input type="checkbox"/> R24A
<input type="checkbox"/> PAD26	<input type="checkbox"/>	<input type="checkbox"/> R26B	<input type="checkbox"/>	<input type="checkbox"/> R26A
<input type="checkbox"/> PAD28	<input type="checkbox"/>	<input type="checkbox"/> R28B	<input type="checkbox"/>	<input type="checkbox"/> R28A
<input type="checkbox"/> PAD30	<input type="checkbox"/>	<input type="checkbox"/> R30B	<input type="checkbox"/>	<input type="checkbox"/> R30A
<input type="checkbox"/> PAD32	<input type="checkbox"/>	<input type="checkbox"/> R32B	<input type="checkbox"/>	<input type="checkbox"/> R32A
<input type="checkbox"/> PAD34	<input type="checkbox"/>	<input type="checkbox"/> R34B	<input type="checkbox"/>	<input type="checkbox"/> R34A
<input type="checkbox"/> PAD36	<input type="checkbox"/>	<input type="checkbox"/> R36B	<input type="checkbox"/>	<input type="checkbox"/> R36A
<input type="checkbox"/> PAD38	<input type="checkbox"/>	<input type="checkbox"/> R38B	<input type="checkbox"/>	<input type="checkbox"/> R38A

DETAIL B

SMT NOTES:

- The Mictor pads are .017" x .070".
- The 0402 pads are .028" x .030"
- The connector pads to the right of the 0402's are .017" x .085".
- The copper plane is .080" x .915".

ALL DIMENSIONS ARE IN INCHES [MM] UNLESS OTHERWISE SPECIFIED

Emulation Technology, Inc.
— VLSI and SMT ADAPTERS and ACCESSORIES —
759 FLYNN ROAD
CAMARILLO, CA 93012
TEL: (805) 383-8480
FAX: (805) 383-8484

SHEET: 1 OF 1
DATE: 04/15/13
REVISION: D

CHECKED: [Signature]
DRAWN: J. GELACIO
ITEM: MIC-38-SMTPADS
DESCRIPTION: MIC-38-SMTPADS

Scale N/A DO NOT SCALE DRAWING
ASSEMBLY DRAWING