

**RoHS Compliant**

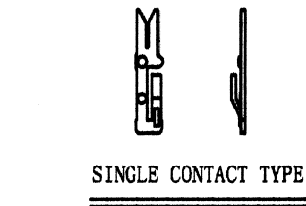
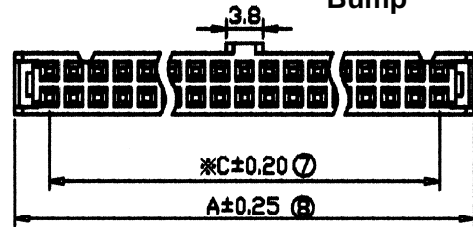
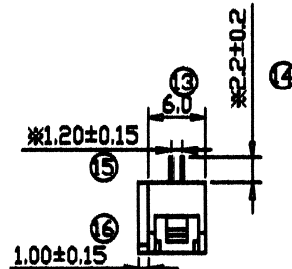
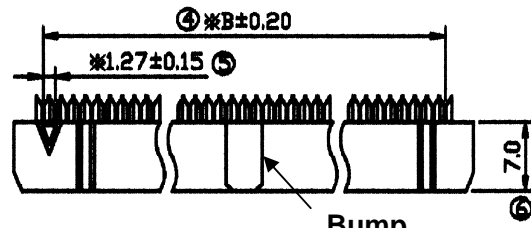
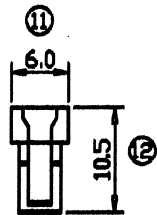
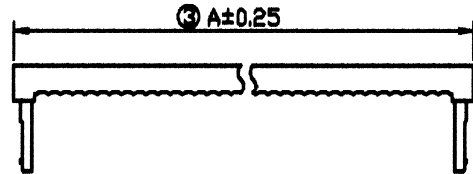
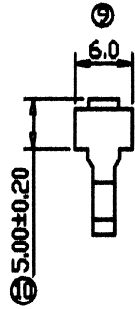
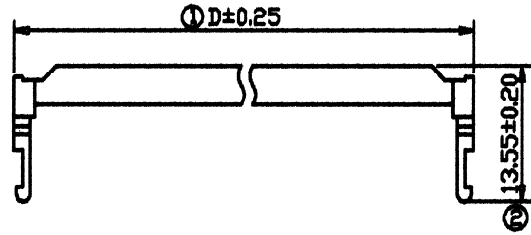

**Materials**

Insulator : PBT, UL 94V-0  
Contact : Copper Alloy

**Specification**

Current rating : 1 Amp  
Insulation resistance : 1,000M Ω min.  
Contact resistance : 1 Ω max.  
Withstanding voltage: AC 500V for 1 minute  
Operating Temperature : - 40°C ~ + 105°C

**Order Information**

**IDC - XX X X** — \*Contact plating  
Series — S - Selective gold, G - Full gold  
\* W - with SR  
\* No. of contacts N - w/o SR

**Note: Normal Insulator color is Black, for Grey color, put (G) at end of p/n.**

No. of contact	Dimensions				No. of contact	Dimensions			
	A	B	C	D		A	B	C	D
8	14.86	8.89	7.62	14.66	30	42.80	36.83	35.56	42.80
10	17.40	11.43	10.16	17.20	34	47.88	41.91	40.64	47.68
12	19.94	13.97	12.70	19.74	36	50.42	44.45	43.18	50.22
14	22.49	16.51	15.24	22.28	40	55.50	49.53	48.26	55.30
16	25.02	19.05	17.78	24.82	44	60.58	54.61	53.34	60.38
18	27.56	21.59	20.32	27.36	50	68.20	62.23	60.96	68.40
20	30.10	24.13	22.86	29.90	60	80.90	74.93	73.66	80.70
24	35.18	29.21	27.94	34.98	64	85.98	80.01	78.84	85.78
26	37.72	31.75	30.48	37.52					