

Technical Data For D-Sub Connectors

Technical Data	D-Subminiature Standard 9, 15, 25, 37 and 50 position	D-Subminiature High Density 15, 25, 44, 62 and 78 position
Insulators	Polyester GF UL 94 V-0	
Contacts	Copper alloy	
Contact finish	hard-gold-plated over nickel	
Shell	tin plated or yellow chromate	
Test voltage V.r.m.s./NM	1000 V	
Working voltage	125 V ≈	60 V ≈
	depending on isolation coordination (refer to DIN VDE 0110 / IEC 664-1)	
Current Rating	7.5 A UL 5 A CSA 5 A VDE	3.0 A UL 2.5 A CSA 3 A VDE
Contact resistance	max. 10 mΩ initially, ΔR max. 10 mΩ after load in accordance DIN 41652, Part 2	
Insulation resistance	≥ 5 GΩ	
Clearance and creepage distance	contact - contact 1.0 mm contact - ground 1.2 mm	≥0.6 mm
Operating temperature	- 55 °C to + 125 °C	
Mating/Unmating forces	9-pol. ≤ 30 N 15-pol. ≤ 50 N 25-pol. ≤ 83 N 37-pol. ≤ 123 N 50-pol. ≤ 167 N	15-pol. ≤ 50 N 26-pol. ≤ 84 N 44-pol. ≤ 120 N 62-pol. ≤ 170 N 78-pol. ≤ 200 N
Quality class	A = Quality class 3 = 50 mating cycles B = Quality class 2 = 200 mating cycles C = Quality class 1 = 500 mating cycles J = Quality class 1 ≥ 500 mating cycles (telecom quality)	



Plug connector

Solder PIN straight
stamped contacts
with through hole

Directive 2002/95/EC
„RoHS“
Compliant

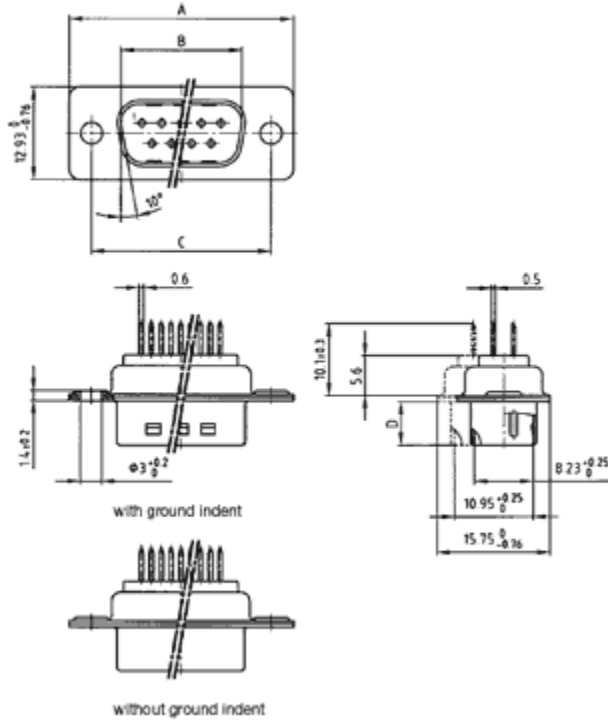

Socket connector

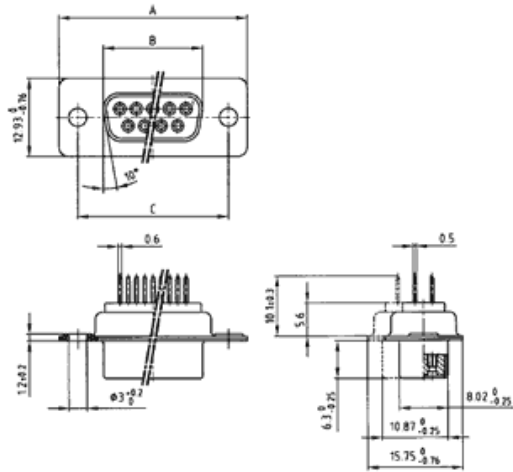

Socket connector:

No. of pos.	A -0,76	B-0,25	C
9	31,19	16,46	25,00 ^{+0,12} _{-0,13}
15	39,52	24,79	33,30 ^{+0,15} _{-0,10}
25	53,42	38,50	47,04 ^{±0,13}
37	69,70	54,96	63,50 ^{±0,13}
50	67,31	52,55	61,10 ^{+0,14} _{-0,11}

Plug connector:

No. of pos.	A -0,76	B+0,25	C	D -0,30
9	31,19	16,79	25,00 ^{+0,12} _{-0,13}	6,12
15	39,52	25,12	33,30 ^{+0,15} _{-0,10}	6,12
25	53,42	38,84	47,04 ^{±0,13}	5,99
37	69,70	55,30	63,50 ^{±0,13}	5,99
50	67,31	52,68	61,10 ^{+0,14} _{-0,11}	5,99

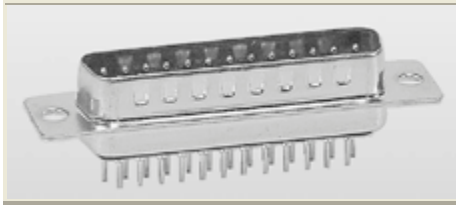

Socket connector

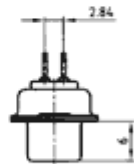
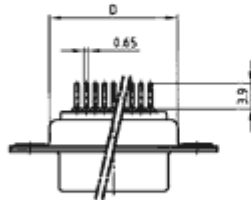
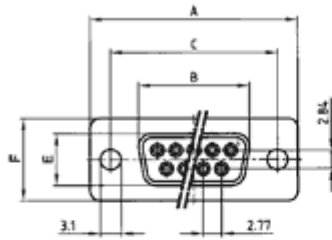

9-37 pos.

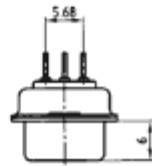

50 pos.

Plug connector

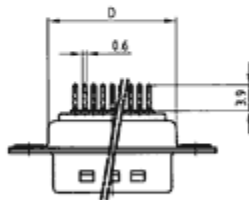
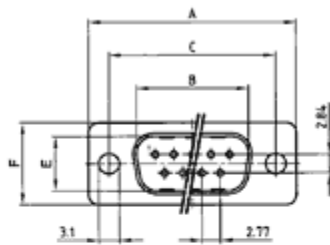

9-37 pos.

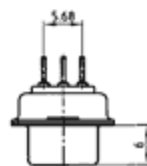

50 pos.

D-Sub Connector
Solder pin straight
stamped contacts
with through hole

Directive 2002/95/EC
"RoHS"
Compliant

Socket connector:

No. of pos.	A	B	C	D	E	F
9	30,80	16,30	25,00	19,20	7,90	12,50
15	39,20	24,60	33,30	27,70	7,90	12,50
25	53,10	38,30	47,10	41,10	7,90	12,50
37	69,40	54,80	63,50	57,30	7,90	12,50
50	67,00	52,20	61,00	55,10	10,90	15,30

Plug connector:

No. of pos.	A	B	C	D	E	F
9	30,80	16,92	25,00	19,20	8,30	12,50
15	39,20	25,25	33,30	27,70	8,30	12,50
25	53,10	38,96	47,10	41,10	8,30	12,50
37	69,40	55,42	63,50	57,30	8,30	12,50
50	67,00	52,81	61,00	55,10	11,30	15,30

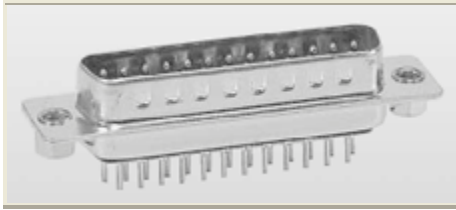

Socket connector

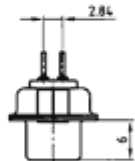
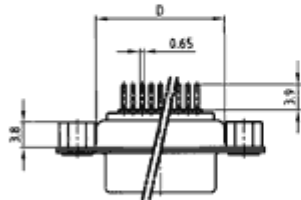
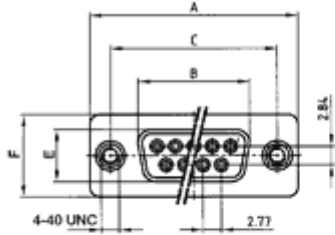

9-37 pos.

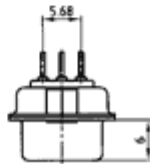

50 pos.

Plug connector

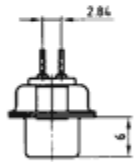
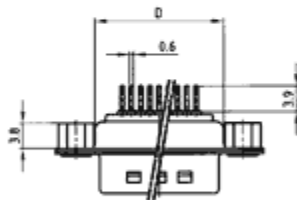
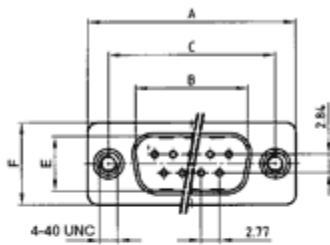

9-37 pos.



50 pos.

D-Sub Connector
Solder pin straight
stamped contacts
with threaded insert

Directive 2002/95/EC
"RoHS"
Compliant

Socket connector:

No. of pos.	A	B	C	D	E	F
9	30,80	16,30	25,00	19,20	7,90	12,50
15	39,20	24,60	33,30	27,70	7,90	12,50
25	53,10	38,30	47,10	41,10	7,90	12,50
37	69,40	54,80	63,50	57,30	7,90	12,50
50	67,00	52,20	61,00	55,10	10,90	15,30

Plug connector:

No. of pos.	A	B	C	D	E	F
9	30,80	16,92	25,00	19,20	8,30	12,50
15	39,20	25,25	33,30	27,70	8,30	12,50
25	53,10	38,96	47,10	41,10	8,30	12,50
37	69,40	55,42	63,50	57,30	8,30	12,50
50	67,00	52,81	61,00	55,10	11,30	15,30

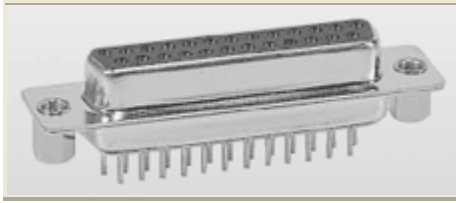

Socket connector

D-Sub Connector
Solder pin straight
stamped contacts
with threaded rear
spacer

Directive 2002/95/EC
„RoHS“
Compliant

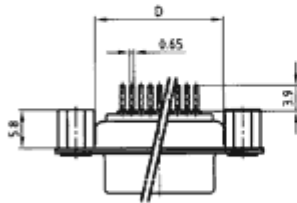
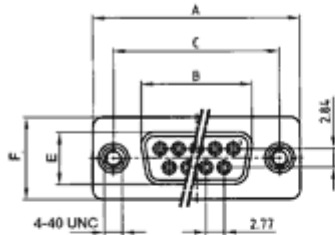

9-37 pos.



50 pos.

Plug connector

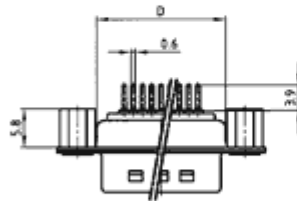
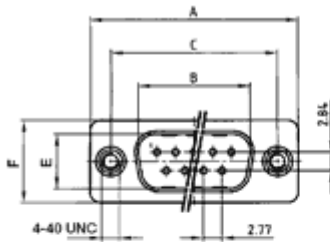

9-37 pos.

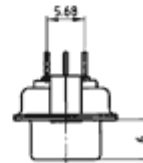

50 pos.

Socket connector:

No. of pos.	A	B	C	D	E	F
9	30,80	16,30	25,00	19,20	7,90	12,50
15	39,20	24,60	33,30	27,70	7,90	12,50
25	53,10	38,30	47,10	41,10	7,90	12,50
37	69,40	54,80	63,50	57,30	7,90	12,50
50	67,00	52,20	61,00	55,10	10,90	15,30

Plug connector:

No. of pos.	A	B	C	D	E	F
9	30,80	16,92	25,00	19,20	8,30	12,50
15	39,20	25,25	33,30	27,70	8,30	12,50
25	53,10	38,96	47,10	41,10	8,30	12,50
37	69,40	55,42	63,50	57,30	8,30	12,50
50	67,00	52,81	61,00	55,10	11,30	15,30

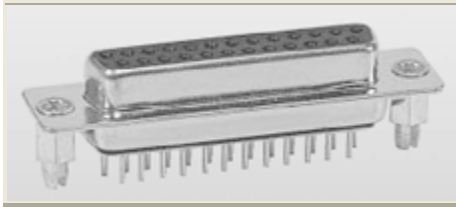

D-Sub Connector
Solder pin straight
stamped contacts
with threaded spacer clip

Directive 2002/95/EC
„RoHS“
Compliant

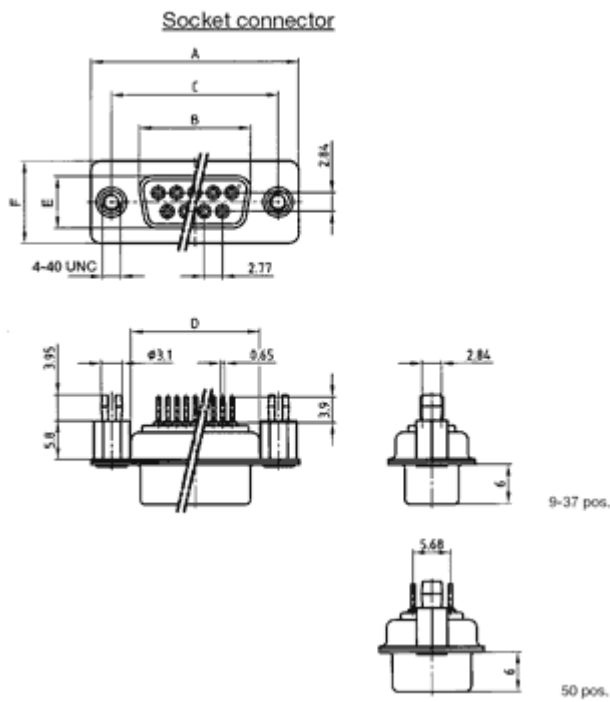

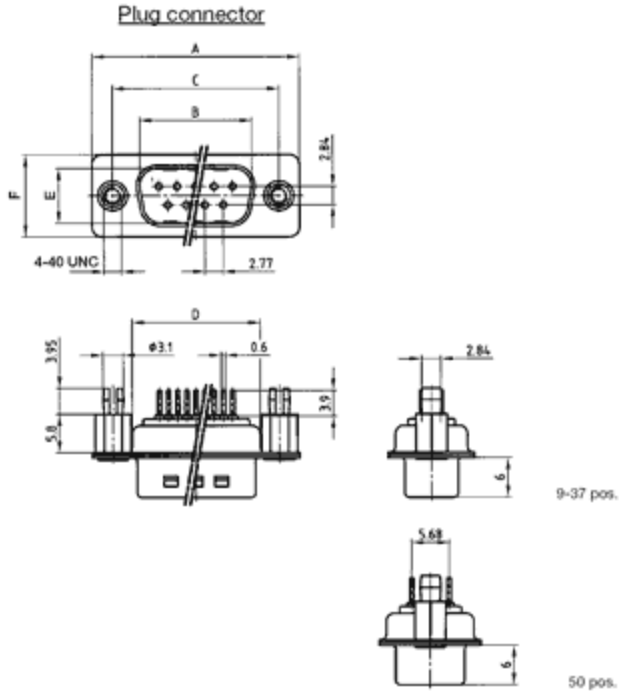

Socket connector:

No. of pos.	A	B	C	D	E	F
9	30,80	16,30	25,00	19,20	7,90	12,50
15	39,20	24,60	33,30	27,70	7,90	12,50
25	53,10	38,30	47,10	41,10	7,90	12,50
37	69,40	54,80	63,50	57,30	7,90	12,50
50	67,00	52,20	61,00	55,10	10,90	15,30

Plug connector:

No. of pos.	A	B	C	D	E	F
9	30,80	16,92	25,00	19,20	8,30	12,50
15	39,20	25,25	33,30	27,70	8,30	12,50
25	53,10	38,96	47,10	41,10	8,30	12,50
37	69,40	55,42	63,50	57,30	8,30	12,50
50	67,00	52,81	61,00	55,10	11,30	15,30

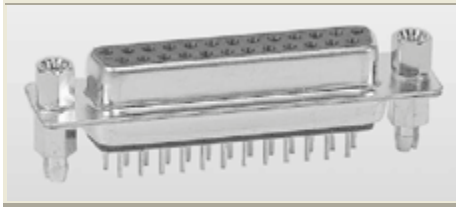

Socket connector

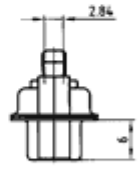
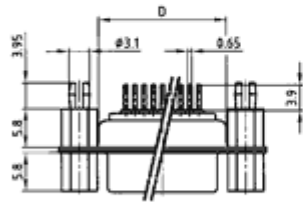
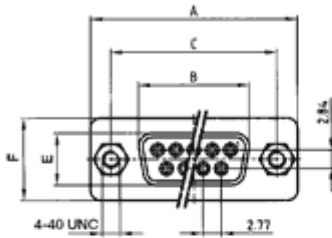

9-37 pos.

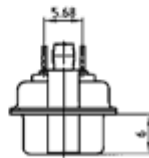

50 pos.

Plug connector

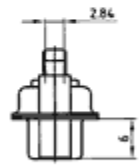
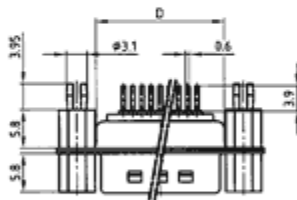
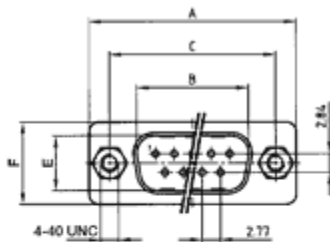

9-37 pos.



50 pos.

D-Sub Connector
Solder pin straight
stamped contacts
with threaded lock
and spacer clip

Directive 2002/95/EC
„RoHS“
Compliant

Socket connector:

No. of pos.	A	B	C	D	E	F
9	30,80	16,30	25,00	19,20	7,90	12,50
15	39,20	24,60	33,30	27,70	7,90	12,50
25	53,10	38,30	47,10	41,10	7,90	12,50
37	69,40	54,80	63,50	57,30	7,90	12,50
50	67,00	52,20	61,00	55,10	10,90	15,30

Plug connector:

No. of pos.	A	B	C	D	E	F
9	30,80	16,92	25,00	19,20	8,30	12,50
15	39,20	25,25	33,30	27,70	8,30	12,50
25	53,10	38,96	47,10	41,10	8,30	12,50
37	69,40	55,42	63,50	57,30	8,30	12,50
50	67,00	52,81	61,00	55,10	11,30	15,30