

Technical Data (Combination D-Sub miniature connectors)

Technical data	Connector with signal contact	Coaxial contacts	High power contacts	High voltage contacts
Insulator (green standard/black crimp)	PBTP,GV (ULV94V-O)			
Shell	Steel			
Shell plating	tin plated or yellow chromate			
Contact plating	gold over nickel			
Contact material	Cu alloy			
Retaining clip		Cu alloy	Cu alloy	PI
Insulators		PTFE/PBTP/PI		PTFE
Current rating (DC)	7.5 A UL 5 A CSA 5 A VDE	2 A UL 2 A CSA	10-40 A UL 10-30 A CSA 10-40 A VDE	2 A UL 2 A CSA
Test voltage between 2 contacts shell and contact	1000V, 50Hz 1 min.			
Resistance between mated contacts	≤2.7 mΩ			
Insulation resistance	≥5 GΩ	≥10 ⁷ MΩ	≥5 GΩ	≥2X10 ⁷ MΩ
Volume resistivity	10 ¹⁶ Ωcm			
Dielectric strength	50KV/mm			
Characteristic impedance		50/75 Ω		
Contact resistance. inner conductor/outer conductor	≤2.7mΩ		≤1mΩ	≤2.7mΩ
VSWR-value at according MIL-C- 39012	1.2GHz		≤1.2	
	1.5GHz		≤1.3	
	2.0GHz		≤1.5	
Dielectric voltage		750V, 50Hz		3.8kV
Frequency range		0-2GHz		
Working Voltage	250V UL 250V CSA 250V VDE	250V UL 250V CSA 250V VDE	300V UL 300V CSA	1000V UL
Temperature range	-55°C to +125°C	-55°C to +135°C	-55°C to +155°C	-55°C to +125°C
Insertion force per signal contact .	≤ 3.4N	≤ 7N	≤ 7N	≤5N
Extraction force per signal contact .	≥ 0.2N	≤ 7N	ca. 5N	ca. 2.5N
Mating cycles	depends on plating thickness	500	500	500

Technical alterations are subject to change without notice

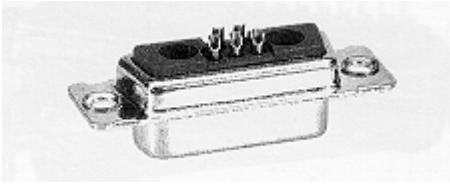

**Combination D-Sub
 Socket Connector
 Solder Cup
 accepts cable AWG 20
 Termination type **M****

Kat 1 i 7AA

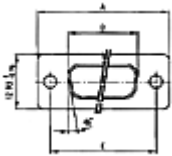

Shellsize	A - 0,76	B - 0,25	C
1	31,19	16,46	25,00 ^{+0,12} _{-0,13}
2	39,52	24,79	33,30 ^{+0,15} _{-0,10}
3	53,42	38,50	47,04 ^{±0,13}
4	69,70	54,96	63,50 ^{±0,13}
5	67,31	52,55	61,10 ^{+0,14} _{-0,11}

Mounting Type

riveted **A1**

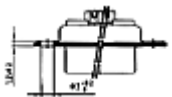

Shellsize 1-4

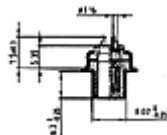

Shellsize 5

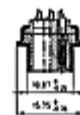

Mounting Type

threaded insert M3 **A2**

4-40 UNC **A3**

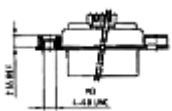

float mount **A6**

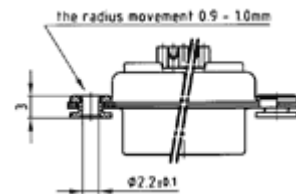

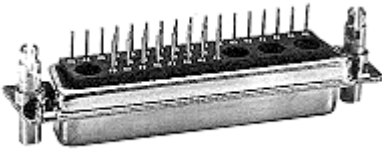

**Combination D-Sub
Socket Connector
Solder Pin straight**

Termination type **R**

Kat 1 i 9AA

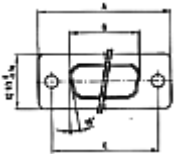

Shellsize	A - 0,76	B - 0,25	C
1	31,19	16,46	25,00 ^{+0,12} _{-0,13}
2	39,52	24,79	33,30 ^{+0,15} _{-0,10}
3	53,42	38,50	47,04 ^{+0,13}
4	69,70	54,96	63,50 ^{+0,13}
5	67,31	52,55	61,10 ^{+0,14} _{-0,11}

Mounting Type

riveted **A1**

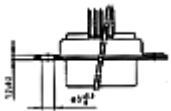

Shellsize 1-4

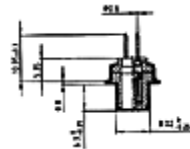

Shellsize 5



Mounting Type

threaded insert

M3 **A2**

4-40 UNC **A3**

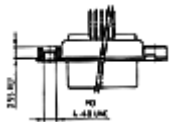

threaded spacer clip

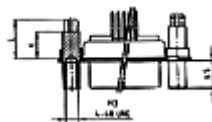

PCB thickness	thread		L ±0,25 mm	K ±0,25 mm
	M 3	4- 40UNC		
1,6 mm	C1	C2	9,4	6,5
	E1	E2	10,3	7,4*
2,3 mm	C3	C4	10,1	6,5
	E3	E4	11,0	7,4*
3,2 mm	C5	C6	11,0	6,5
	E5	E6	11,9	7,4*

* Dim according D-Sub standard

Mounting Type

threaded rear spacer

M3 **A4**

4-40 UNC **A5**

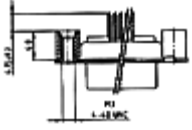

threaded lock and spacer clip

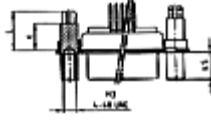

PCB thickness	thread		L ±0.25 mm	K ±0.25 mm
	M 3	4- 40UNC		
1,6 mm	D1	D2	9,4	6,5
	F1	F2	10,3	7,4*
2,3 mm	D3	D4	10,1	6,5
	F3	F4	11,0	7,4*
3,2 mm	D5	D6	11,0	6,5
	F5	F6	11,9	7,4*

* For use with standard D-Sub series to maintain uniform height on PCB

Clip for PCB Ø3.1mm ±0.1mm

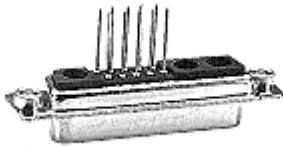

**Combination D-Sub
Socket Connector
Wire wrap - 3 level
Termination type N**

Kat 2 i 7AA

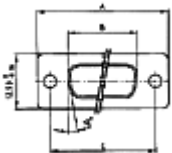

Shellsize	A - 0,76	B - 0,25	C
1	31,19	16,46	25,00 ^{+0,12} _{-0,13}
2	39,52	24,79	33,30 ^{+0,15} _{-0,10}
3	53,42	38,50	47,04 ^{±0,13}
4	69,70	54,96	63,50 ^{±0,13}
5	67,31	52,55	61,10 ^{+0,14} _{-0,11}

Mounting Type

riveted **A1**

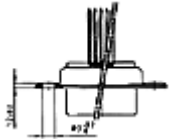

Shellsize 1-4

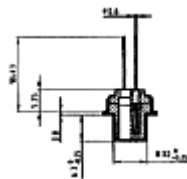

Shellsize 5



Mounting type

threaded insert
M3 **A2**
4-40 UNC **A3**

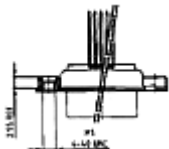



**Combination D-Sub
 Socket Connector
 Solder pin angled .370 inch
 Raised mounting
 Termination type U**

Kat 2 i 5PA

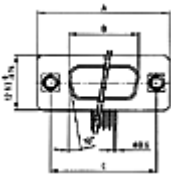

Shellsize	A - 0,76	B - 0,25	C
1	31,19	16,46	25,00 ^{+0,12} _{-0,13}
2	39,52	24,79	33,30 ^{+0,15} _{-0,10}
3	53,42	38,50	47,04 ^{±0,13}
4	69,70	54,96	63,50 ^{±0,13}
5	67,31	52,55	61,10 ^{+0,14} _{-0,11}

Raised Mounting Type

threaded insert and metal bracket

M3 **G1**

threaded insert and metal bracket 4-40 UNC **G2** Shellsize 1-4

Shellsize 5

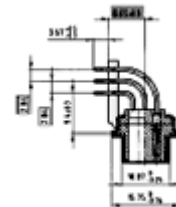
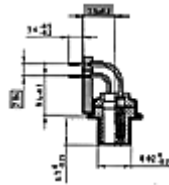
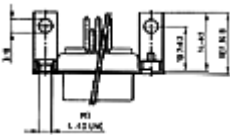

Raised Mounting Type

threaded insert, metal bracket
and clip

M3 **G3**

threaded insert, metal bracket
and clip 4-40 UNC **G4**

threaded lock and metal
bracket

M3 **H1**

threaded insert, metal bracket
and clip 4-40 UNC **H2**

threaded lock, metal bracket
and clip

M3 **H3**

threaded insert, metal bracket
and clip 4-40 UNC **H4**

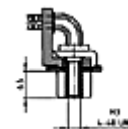
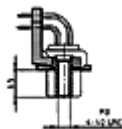

Clip for PCB Ø3.1 mm ±0.1 mm, PCB thickness = 1.6mm



**Combination D-Sub
Socket Connector
Solder pin angled .370"
Connector with metal bracket flush mounting
Termination type U**

Kat 1 i 1BA

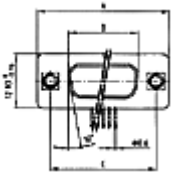

Shellsize	A - 0,76	B - 0,25	C
1	31,19	16,46	25,00 ^{+0,12} _{-0,13}
2	39,52	24,79	33,30 ^{+0,15} _{-0,10}
3	53,42	38,50	47,04 ^{±0,13}
4	69,70	54,96	63,50 ^{±0,13}
5	67,31	52,55	61,10 ^{+0,14} _{-0,11}

Flush Mounting Type

threaded insert and metal
bracket

M3 K1

threaded insert and metal
bracket 4-40 UNC **K2**

Shellsize 1-4

Shellsize 5

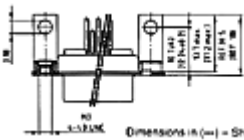

Dimensions in (---) = Shellsize 5

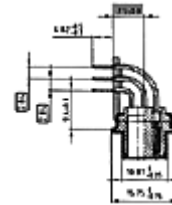
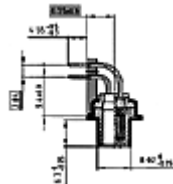

Flush Mounting Type

threaded insert, metal
bracket and clip

M3 K3

threaded insert, metal
bracket and clip 4-40
UNC **K4**

threaded lock and
metal bracket

M3 L1

threaded lock and
metal bracket 4-40
UNC **L2**

threaded lock, metal
bracket and clip

M3 L3

threaded lock, metal
bracket and clip 4-40
UNC **L4**

riveted **A1**

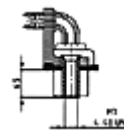
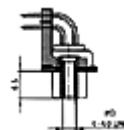
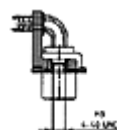
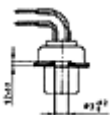

Clip for PCB Ø3.1 mm ±0.1 mm, PCB thickness = 1.6mm

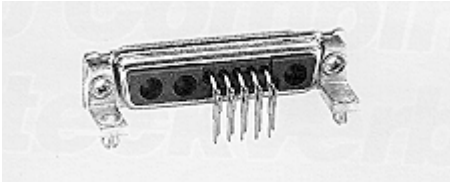

**Combination D-Sub
Socket Connector
Solder pin angled .318"
Termination type T**

Kat 1 i 3BA

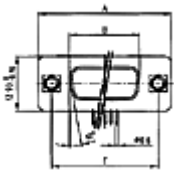

Shellsize	A - 0,76	B - 0,25	C
1	31,19	16,46	25,00 ^{+0,12} _{-0,13}
2	39,52	24,79	33,30 ^{+0,15} _{-0,10}
3	53,42	38,50	47,04 ^{±0,13}
4	69,70	54,96	63,50 ^{±0,13}
5	67,31	52,55	61,10 ^{+0,14} _{-0,11}

Flush Mounting Type

threaded insert and metal
bracket
M3 N1
threaded insert and metal
bracket 4-40 UNC **N2**

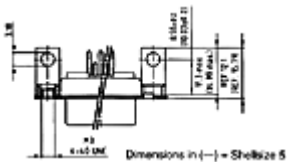

Dimensions in (---) = Shellsize 5

Shellsize 1-4

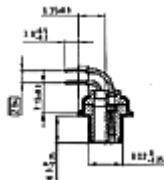

Shellsize 5

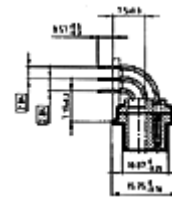

Flush Mounting Type

	threaded insert, metal bracket and clip M3 N3	threaded lock and metal bracket M3 P1	threaded lock, metal bracket and clip M3 P3
	threaded insert, metal bracket and clip 4-40 UNC N4	threaded lock and metal bracket 4-40 UNC P2	threaded lock, metal bracket and clip 4-40 UNC P4
riveted A1			

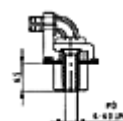
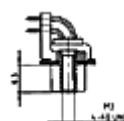
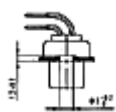

Clip for PCB Ø3.1 mm ±0.1 mm, PCB thickness = 1.6mm



**Combination D-Sub
Socket Connector
without signal contacts
Termination type X**

Kat 1 i 5BA

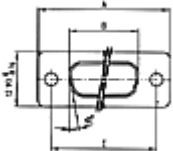

Shellsize	A - 0,76	B - 0,25	C
1	31,19	16,46	25,00 ^{+0,12} _{-0,13}
2	39,52	24,79	33,30 ^{+0,15} _{-0,10}
3	53,42	38,50	47,04 ^{±0,13}
4	69,70	54,96	63,50 ^{±0,13}

**Contact Arrangement:
3W3, 5W5, 8W8, 2W2C, 3W3C (Coded Types)**

Mixed version

2W2C = 1 plug + 1 socket contact
3W3C = 2 socket + 1 plug contact

Mounting Type

riveted **A1**

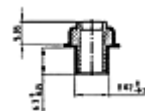

Mounting Type

threaded insert M3 **A2**

threaded insert 4-40 UNC **A3**

threaded spacer clip

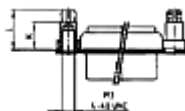
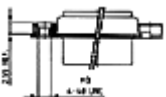

PCB thickness	thread		L ±0,25 mm	K ±0,25 mm
	M 3	4- 40UNC		
1,6 mm	C1	C2	9,4	6,5
	E1	E2	10,3	7,4*
2,3 mm	C3	C4	10,1	6,5
	E3	E4	11,0	7,4*
3,2 mm	C5	C6	11,0	6,5
	E5	E6	11,9	7,4*

Mounting Type

threaded rear spacer M3 **A4**

threaded rear spacer 4-40 UNC **A5**

threaded lock and spacer clip

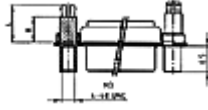
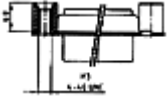

PCB thickness	thread		L ±0.25 mm	K ±0.25 mm
	M 3	4- 40UNC		
1,6 mm	D1	D2	9,4	6,5
	F1	F2	10,3	7,4*
2,3 mm	D3	D4	10,1	6,5
	F3	F4	11,0	7,4*
3,2 mm	D5	D6	11,0	6,5
	F5	F6	11,9	7,4*

* For use with standard D-Subminiature Series to maintain uniform height on PCB.

Clip for PCB Ø3.1 mm ±0.1 mm



**Combination D-Sub
Socket Connector
without signal contacts for solder pin angled .370"
Raised mounting
Termination type X**

Kat 4 i 5BA

Click Diagrams
For Larger View

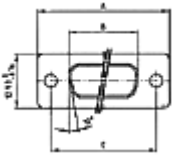

Shellsize	A - 0,76	B - 0,25	C
1	31,19	16,46	25,00 ^{+0,12} _{-0,13}
2	39,52	24,79	33,30 ^{+0,15} _{-0,10}
3	53,42	38,50	47,04 ^{±0,13}
4	69,70	54,96	63,50 ^{±0,13}

**Contact Arrangement:
3W3, 5W5, 8W8, 2W2C, 3W3C (Coded Types)**

Mixed version

2W2C = 1 plug + 1 socket contact
3W3C = 2 socket + 1 plug contact

Raised Mounting Type

threaded insert and metal bracket

M3 **G1**

threaded insert and metal bracket 4-40 UNC **G2**

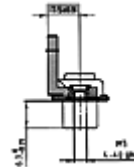
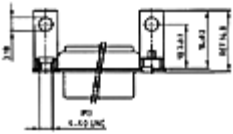

Raised Mounting Type

threaded insert, metal bracket and clip
M3 **G3**

threaded insert, metal bracket and clip
4-40 UNC **G4**

threaded lock and metal bracket
M3 **H1**

threaded lock and metal bracket 4-40
UNC **H2**

threaded lock, metal bracket and clip
M3 **H3**

threaded lock, metal bracket and clip
4-40 UNC **H4**

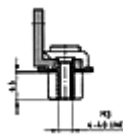
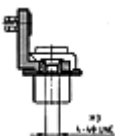

Clip for PCB Ø3.1 mm ±0.1 mm, PCB thickness = 1.6mm



**Combination D-Sub
Socket Connector
without signal contacts for solder pin angled .370"
connector with metal bracket flush mounting
Termination type X**

Kat 3 i 5BA

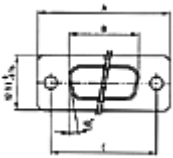

Shellsize	A - 0,76	B - 0,25	C
1	31,19	16,46	25,00 ^{+0,12} _{-0,13}
2	39,52	24,79	33,30 ^{+0,15} _{-0,10}
3	53,42	38,50	47,04 ^{±0,13}
4	69,70	54,96	63,50 ^{±0,13}

Contact Arrangement:
3W3, 5W5, 8W8,
2W2C, 3W3C (Coded Types)

Mixed version
2W2C = 1 plug + 1 socket contact
3W3C = 2 socket + 1 plug contact

Flush Mounting Type

threaded insert and metal bracket

M3 **K1**

threaded insert and metal bracket 4-40 UNC **K2**

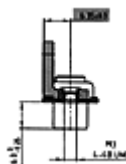
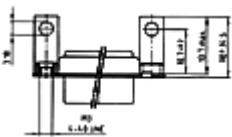

Flush Mounting Type

threaded insert, metal bracket and clip
M3 **K3**

threaded insert, metal bracket and clip
4-40 UNC **K4**

threaded lock and metal bracket
M3 **L1**

threaded lock and metal bracket 4-40
UNC **L2**

threaded lock, metal bracket and clip
M3 **L3**

threaded lock, metal bracket and clip
4-40 UNC **L4**

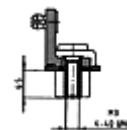
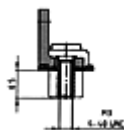
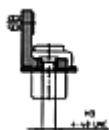

Clip for PCB Ø3.1 mm ±0.1 mm, PCB thickness = 1.6mm



**Combination D-Sub
Socket Connector
without signal contacts for solder pin angled .318"
Termination type X**

Kat 2 i 5BA

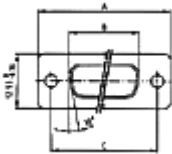

Shellsize	A - 0,76	B - 0,25	C
1	31,19	16,46	25,00 ^{+0,12} _{-0,13}
2	39,52	24,79	33,30 ^{+0,15} _{-0,10}
3	53,42	38,50	47,04 ^{±0,13}
4	69,70	54,96	63,50 ^{±0,13}

**Contact Arrangement:
3W3, 5W5, 8W8, 2W2C, 3W3C (Coded Types)**

Mixed version
2W2C = 1 plug + 1 socket contact
3W3C = 2 socket + 1 plug contact

Mounting Type

threaded insert and metal bracket
M3 **N1**
threaded insert and metal bracket 4-40 UNC **N2**

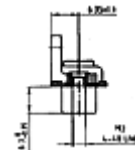
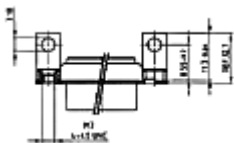

Mounting Type

threaded insert, metal bracket and clip M3 N3	threaded lock and metal bracket M3 P1	threaded lock, metal bracket and clip M3 P3
threaded insert, metal bracket and clip 4-40 UNC N4	threaded lock and metal bracket 4-40 UNC P2	threaded lock, metal bracket and clip 4-40 UNC P4

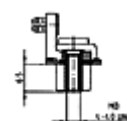
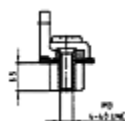
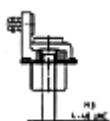

Clip for PCB Ø3.1 mm ±0.1 mm, PCB thickness = 1.6mm



**Combination D-Sub
Socket Connector**

Press-fit technology

Termination type **P**

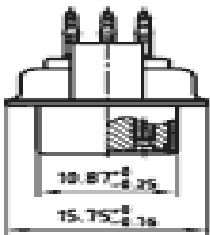

Shellsize	A - 0,76	B - 0,25	C
1	31,19	16,46	25,00 ^{+0,12} _{-0,13}
2	39,52	24,79	33,30 ^{+0,15} _{-0,10}
3	53,42	38,50	47,04 ^{±0,13}
4	69,70	54,96	63,50 ^{±0,13}
5	67,31	52,55	61,10 ^{+0,14} _{-0,11}

= Ordering code

Mounting Type

threaded rear spacer M3 **A7**

threaded rear spacer 4-40 UNC **A8**

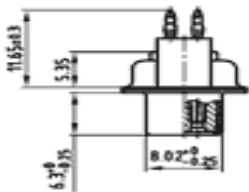

Shellsize 1-4

Shellsize 5

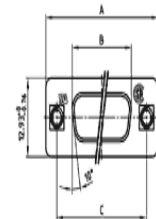
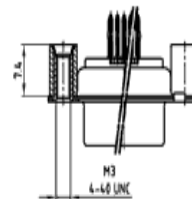

Mounting type

Threaded rear spacer with push in pin M3 **W1**

Threaded rear spacer with push in pin 4-40 UNC **W2**

P.C.B. hole for push in pin

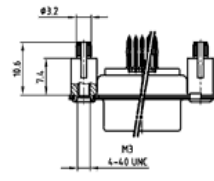
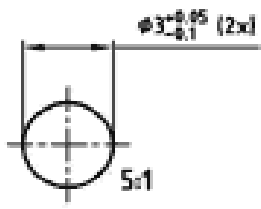



**Combination D-Sub
 Plug Connector
 Solder Cup
 accepts cable AWG 20
 Termination type **M****

Kat 1 i 8AA

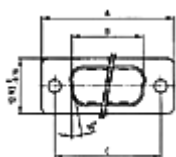

Shellsize	A - 0,76	B + 0,25	C	D - 0,30
1	31,19	16,79	25,00 ^{+0,12} _{-0,13}	6,12
2	39,52	25,12	33,30 ^{+0,15} _{-0,10}	6,12
3	53,42	38,84	47,04 ^{±0,13}	5,99
4	69,70	55,30	63,50 ^{±0,13}	5,99
5	67,31	52,68	61,10 ^{+0,14} _{-0,11}	5,99

= Ordering code

Mounting Type

riveted **A1**

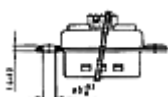

Shellsize 1-4

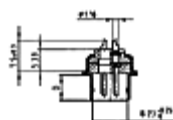

Shellsize 5



Mounting Type

threaded insert

M3 **A2**

4-40 UNC **A3**



float mount **A6**

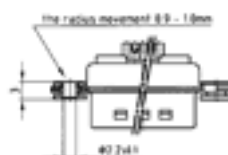



**Combination D-Sub
Plug Connector
Solder Pin straight
Termination type R**

Kat 1 i 0BA

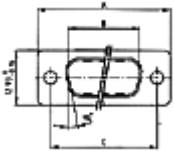

Shellsize	A - 0,76	B + 0,25	C	D - 0,30
1	31,19	16,79	25,00 ^{+0,12 -0,13}	6,12
2	39,52	25,12	33,30 ^{+0,15 -0,10}	6,12
3	53,42	38,84	47,04 ^{±0,13}	5,99
4	69,70	55,30	63,50 ^{±0,13}	5,99
5	67,31	52,68	61,10 ^{+0,14 -0,11}	5,99

Mounting Type

riveted **A1**

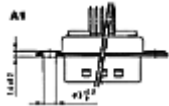

Shellsize 1-4

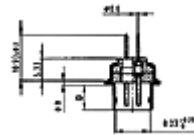

Shellsize 5



Mounting Type

threaded insert
M3 **A2**
4-40 UNC **A3**

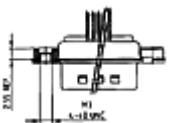

threaded spacer clip

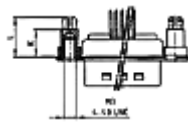

PCB thickness	thread		L ±0,25 mm	K ±0,25 mm
	M 3	4- 40UNC		
1,6 mm	C1	C2	9,4	6,5
	E1	E2	10,3	7,4*
2,3 mm	C3	C4	10,1	6,5
	E3	E4	11,0	7,4*
3,2 mm	C5	C6	11,0	6,5
	E5	E6	11,9	7,4*

Mounting Type

threaded rear spacer
M3 **A4**
4-40 UNC **A5**

threaded lock and spacer clip

PCB	thread	L	K
-----	--------	---	---



**Combination D-Sub
Plug Connector
Wire wrap - 3 level
Termination type N**

Kat 2 i 8AA

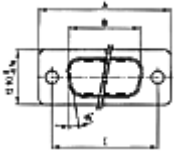

Shellsize	A - 0,76	B + 0,25	C	D - 0,30
1	31,19	16,79	25,00 ^{+0,12} _{-0,13}	6,12
2	39,52	25,12	33,30 ^{+0,15} _{-0,10}	6,12
3	53,42	38,84	47,04 ^{±0,13}	5,99
4	69,70	55,30	63,50 ^{±0,13}	5,99
5	67,31	52,68	61,10 ^{+0,14} _{-0,11}	5,99

Mounting Type

riveted **A1**

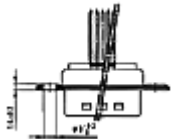

Shellsize 1-4

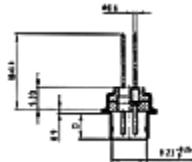

Shellsize 5

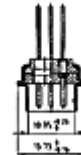

Mounting type

threaded insert
M3 **A2**
4-40 UNC **A3**

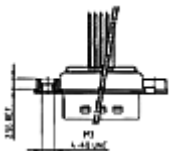



**Combination D-Sub
Plug Connector
Solder pin angled .370"
Raised mounting
Termination type U**

Kat 2 i 6PA

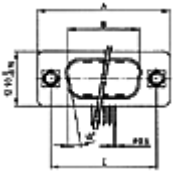

Shellsize	A - 0,76	B + 0,25	C	D - 0,30
1	31,19	16,79	25,00 ^{+0,12} _{-0,13}	6,12
2	39,52	25,12	33,30 ^{+0,15} _{-0,10}	6,12
3	53,42	38,84	47,04 ^{±0,13}	5,99
4	69,70	55,30	63,50 ^{±0,13}	5,99
5	67,31	52,68	61,10 ^{+0,14} _{-0,11}	5,99

Raised Mounting Type

threaded insert and metal bracket

M3 **G1**

threaded insert and metal bracket 4-40 UNC

G2

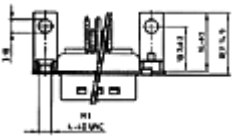

Shellsize 1-4

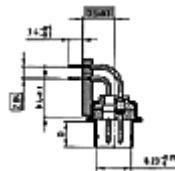

Shellsize 5

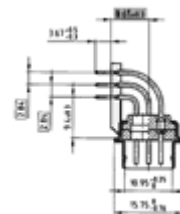

Raised Mounting Type

threaded insert, metal bracket
and clip

M3 **G3**

threaded insert, metal bracket
and clip 4-40 UNC **G4**

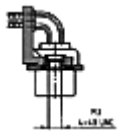

threaded lock and metal
bracket

M3 **H1**

threaded lock and metal
bracket 4-40 UNC **H2**

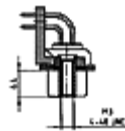

threaded lock, metal bracket
and clip

M3 **H3**

threaded lock, metal bracket
and clip 4-40 UNC **H4**

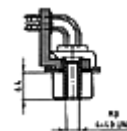

Clip for PCB Ø3.1 mm ±0.1 mm, PCB thickness = 1.6mm

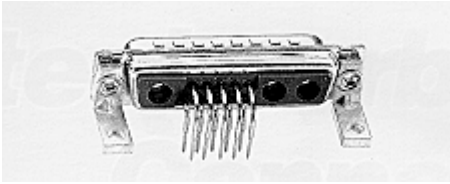

**Combination D-Sub
Plug Connector**
Solder pin angled .370 inch
with metal bracket flush mounting
Termination type U

Kat 2 i 6PA

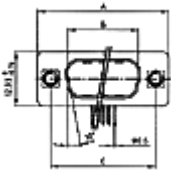

Shellsize	A - 0,76	B + 0,25	C	D - 0,30
1	31,19	16,79	25,00 ^{+0,12} _{-0,13}	6,12
2	39,52	25,12	33,30 ^{+0,15} _{-0,10}	6,12
3	53,42	38,84	47,04 ^{±0,13}	5,99
4	69,70	55,30	63,50 ^{±0,13}	5,99
5	67,31	52,68	61,10 ^{+0,14} _{-0,11}	5,99

Mounting Type

threaded insert and metal
bracket

M3 K1

threaded insert and metal
bracket 4-40 UNC **K2**

Shellsize 1-4

Shellsize 5

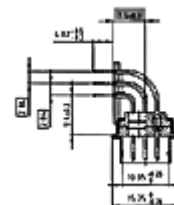
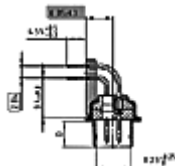
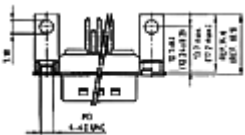

Mounting Type

threaded insert, metal
bracket and clip

M3 K3

threaded insert, metal
bracket and clip 4-40
UNC **K4**

threaded lock and
metal bracket

M3 L1

threaded lock and
metal bracket 4-40
UNC **L2**

threaded lock, metal
bracket and clip

M3 L3

threaded lock, metal
bracket and clip 4-40
UNC **L4**

riveted **A1**

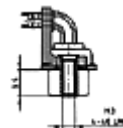
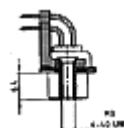
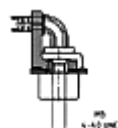
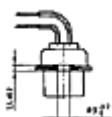

Clip for PCB $\varnothing 3.1 \text{ mm} \pm 0.1 \text{ mm}$, PCB thickness = 1.6mm

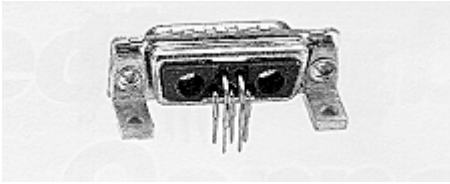

**Combination D-Sub
Plug Connector
Solder pin angled .318"
Termination type T**

Kat 1 i 4BA

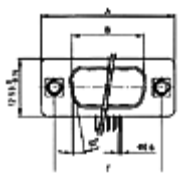

Shellsize	A - 0,76	B + 0,25	C	D - 0,30
1	31,19	16,79	25,00 ^{+0,12} _{-0,13}	6,12
2	39,52	25,12	33,30 ^{+0,15} _{-0,10}	6,12
3	53,42	38,84	47,04 ^{±0,13}	5,99
4	69,70	55,30	63,50 ^{±0,13}	5,99
5	67,31	52,68	61,10 ^{+0,14} _{-0,11}	5,99

Flush Mounting Type

threaded insert and metal
bracket M3 **N1**
threaded insert and metal
bracket 4-40 UNC **N2**

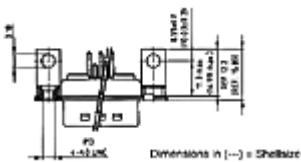

Shellsize 1-4

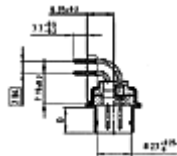

Shellsize 5

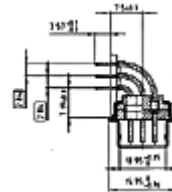

Flush Mounting Type

	threaded insert, metal bracket and clip M3 N3 threaded insert, metal bracket and clip 4-40 UNC N4	threaded lock and metal bracket M3 P1 threaded lock and metal bracket 4-40 UNC P2	threaded lock, metal bracket and clip M3 P3 threaded lock, metal bracket and clip 4-40 UNC P4
riveted A1			

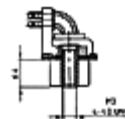
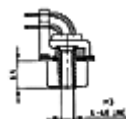
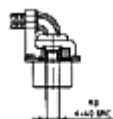
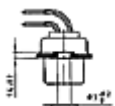

Clip for PCB Ø3.1 mm ±0.1 mm, PCB thickness = 1.6mm



**Combination D-Sub
Plug Connector
without signal contacts
Termination type X**

Kat 1 i 6BA

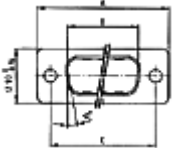

Shellsize	A - 0,76	B + 0,25	C	D - 0,30
1	31,19	16,79	25,00 ^{+0,12} _{-0,13}	6,12
2	39,52	25,12	33,30 ^{+0,12} _{-0,10}	6,12
3	53,42	38,84	47,04 ^{+0,13}	5,99
4	69,70	55,30	63,50 ^{+0,13}	5,99

Contact Arrangement:
3W3, 5W5, 8W8, 2W2C, 3W3C (Coded Types)

Mixed version
2W2C = 1 plug + 1 socket contact
3W3C = 2 plug + 1 socket contact

Mounting Type

riveted **A1**

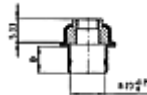
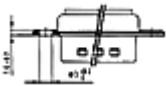

Mounting Type

threaded insert M3 **A2**
threaded insert 4-40 UNC **A3**

threaded spacer clip

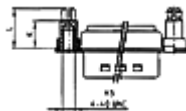
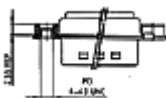

PCB thickness	thread		L ±0,25 mm	K ±0,25 mm
	M 3	4- 40UNC		
1,6 mm	C1	C2	9,4	6,5
	E1	E2	10,3	7,4*
2,3 mm	C3	C4	10,1	6,5
	E3	E4	11,0	7,4*
3,2 mm	C5	C6	11,0	6,5
	E5	E6	11,9	7,4*

Mounting Type

threaded rear spacer M3 **A4**

threaded rear spacer 4-40 UNC threaded lock and spacer clip

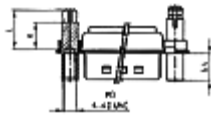
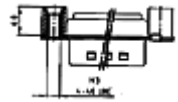

PCB thickness	thread		L ±0.25 mm	K ±0.25 mm
	M 3	4- 40UNC		
1,6 mm	D1	D2	9,4	6,5
	F1	F2	10,3	7,4*
2,3 mm	D3	D4	10,1	6,5
	F3	F4	11,0	7,4*
3,2 mm	D5	D6	11,0	6,5
	F5	F6	11,9	7,4*

* For use with standard D-Subminiature Series to maintain uniform height on PCB.

Clip for PCB Ø3.1 mm ±0.1 mm



**Combination D-Sub
Plug Connector
without signal contacts for solder pin angled .370 inch
Raised mounting
Termination type X**

Kat 4 i 6BA

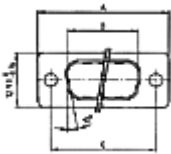

Shellsize	A - 0,76	B + 0,25	C	D - 0,30
1	31,19	16,79	25,00 ^{+0,12} _{-0,13}	6,12
2	39,52	25,12	33,30 ^{+0,12} _{-0,10}	6,12
3	53,42	38,84	47,04 ^{±0,13}	5,99
4	69,70	55,30	63,50 ^{±0,13}	5,99

**Contact Arrangement:
3W3, 5W5, 8W8, 2W2C, 3W3C (Coded Types)**

Mixed version

2W2C = 1 plug + 1 socket contact

3W3C = 2 plug + 1 socket contact

Raised Mounting Type

threaded insert and metal bracket

M3 **G1**

threaded insert and metal bracket 4-40 UNC **G2**

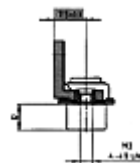
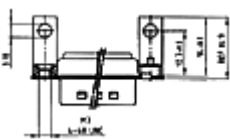

Raised Mounting Type

threaded insert, metal bracket
and clip

M3 **G3**

threaded insert, metal bracket
and clip 4-40 UNC **G4**

threaded lock and metal
bracket

M3 **H1**

threaded lock and metal
bracket 4-40 UNC **H2**

threaded lock, metal bracket
and clip

M3 **H3**

threaded lock, metal bracket
and clip 4-40 UNC **H4**

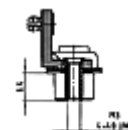
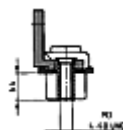
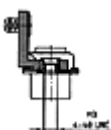

Clip for PCB Ø3.1 mm ±0.1 mm, PCB thickness = 1.6mm



**Combination D-Sub
Plug Connector**

without signal contacts for solder pin angled .370" connector with metal bracket flush mounting

Termination type X

Kat 3 i 6BA

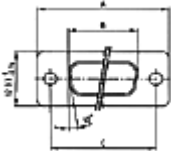

Shellsize	A - 0,76	B - 0,25	C
1	31,19	16,46	25,00 ^{+0,12} _{-0,13}
2	39,52	24,79	33,30 ^{+0,15} _{-0,10}
3	53,42	38,50	47,04 ^{±0,13}
4	69,70	54,96	63,50 ^{±0,13}

Contact Arrangement:

3W3, 5W5, 8W8, 2W2C, 3W3C (Coded Types)

Mixed version

2W2C = 1 plug + 1 socket contact

3W3C = 2 plug + 1 socket contact

Mounting Type

threaded insert and metal bracket

M3 K1

threaded insert and metal bracket 4-40 UNC **K2**

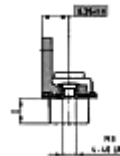
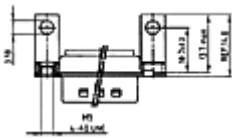

Mounting Type

threaded insert, metal bracket and clip
M3 K3

threaded insert, metal bracket and clip
4-40 UNC **K4**

threaded lock and metal bracket
M3 L1

threaded lock and metal bracket 4-40
UNC **L2**

threaded lock, metal bracket and clip
M3 L3

threaded lock, metal bracket and clip
4-40 UNC **L4**

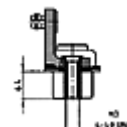
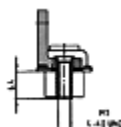
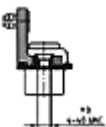

Clip for PCB Ø3.1 mm ±0.1 mm, PCB thickness = 1.6mm

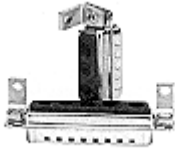

**Combination D-Sub
Plug Connector
without signal contacts for solder pin angled .318"
Termination type X**

Kat 2 i 6BA

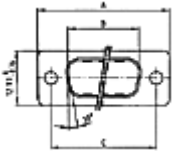

Shellsize	A - 0,76	B + 0,25	C	D - 0,30
1	31,19	16,79	25,00 ^{+0,12} _{-0,13}	6,12
2	39,52	25,12	33,30 ^{+0,12} _{-0,10}	6,12
3	53,42	38,84	47,04 ^{±0,13}	5,99
4	69,70	55,30	63,50 ^{±0,13}	5,99

**Contact Arrangement:
3W3, 5W5, 8W8, 2W2C, 3W3C (Coded Types)**

Mixed version

2W2C = 1 plug + 1 socket contact

3W3C = 2 plug + 1 socket contact

Mounting Type

threaded insert and metal bracket

M3 N1

threaded insert and metal bracket 4-40 UNC N2

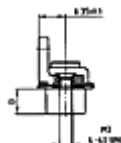
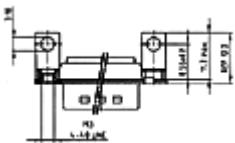

Mounting Type

threaded insert, metal bracket and clip
M3 N3

threaded insert, metal bracket and clip
4-40 UNC N4

threaded lock and metal bracket
M3 P1

threaded lock and metal bracket 4-40
UNC P2

threaded lock, metal bracket and clip
M3 P3

threaded lock, metal bracket and clip
4-40 UNC P4

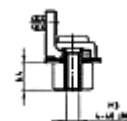
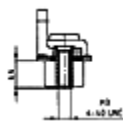
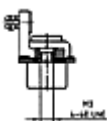

Clip for PCB Ø3.1 mm ±0.1 mm, PCB thickness = 1.6mm



**Combination D-Sub
Plug Connector**

Press-fit technology
Termination type **P**

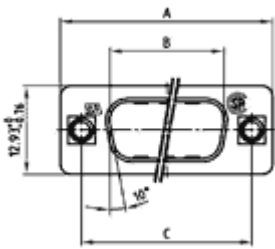

Shellsize	A - 0,76	B + 0,25	C	D - 0,30
1	31,19	16,79	25,00 ^{+0,12} _{-0,13}	6,12
2	39,52	25,12	33,30 ^{+0,15} _{-0,10}	6,12
3	53,42	38,84	47,04 ^{±0,13}	5,99
4	69,70	55,30	63,50 ^{±0,13}	5,99
5	67,31	52,68	61,10 ^{+0,14} _{-0,11}	5,99

Mounting Type

threaded rear spacer M3 **A7**

threaded rear spacer 4-40 UNC **A8**

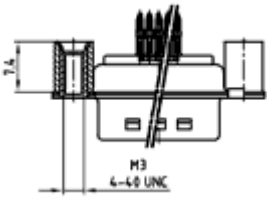

Shellsize 1-4

Shellsize 5

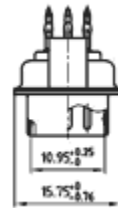
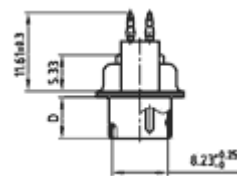

Mounting type

Threaded rear spacer with push in pin M3 **W1**

Threaded rear spacer with push in pin 4-40 UNC **W2** P.C.B. hole for push in pin

