

RoHS Compliant

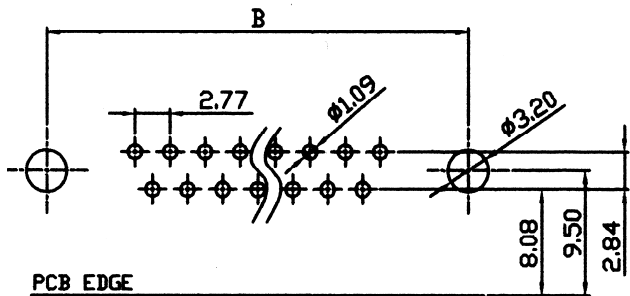

Recommended PCB Layout

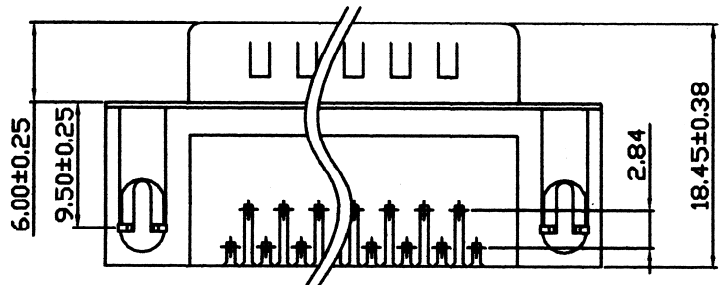
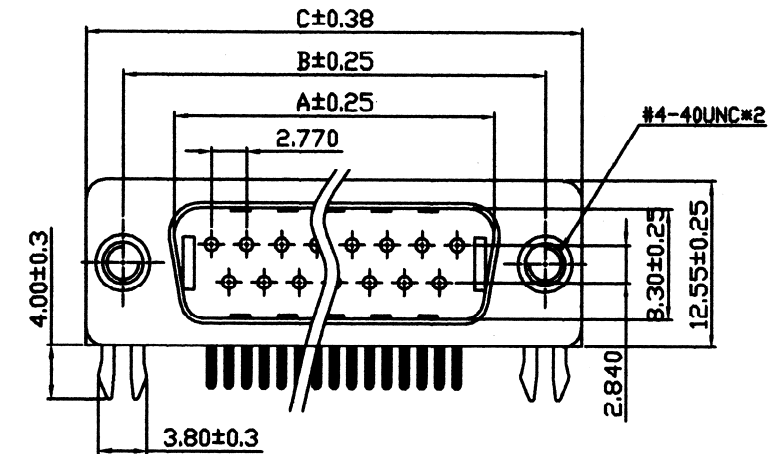
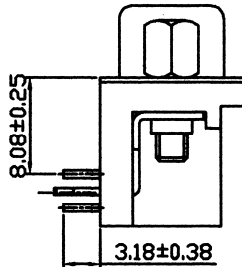

Standard

Options :

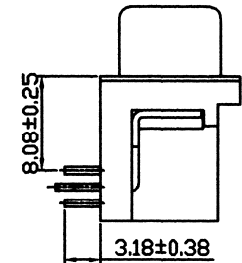

(01) - #4-40 Rivted
Screws optioned

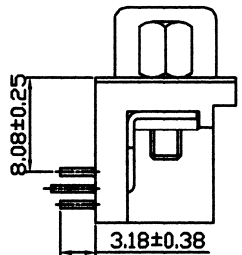

(02) - #4-40 Rivted
Screws locked

Material & Finishes

Insulator : PBT, UL 94V-0

Contact : Brass, Gold flash plated on mating area

Sn plated on soldertails

Nickel under plated overall

Shell : SPCC, Nickel plated

Rivet : Copper alloy, Nickel plated

Board lock : Copper alloy, Sn plated

Screw : SPCC or Copper alloy, Nickel plated

Specification

Current rating : 1 Amp max.

Insulation Resistance : 1,000 Mohm min. at DC 500V

Contact resistance : 30 mOhm max.

Dielectric withstanding voltage : 500V AC for 1 minute

Operation temperature : - 55°C ~ + 105°C

Dimensions

Contact	A	B	C
09	16.33	24.99	30.80
15	25.25	33.32	39.14
25	38.38	47.04	53.04
37	55.42	63.50	69.32

Order Information

DR - 00 M X X

*** Options:**

Put (01), or (02), or others on end of P/N

* Contacts plating: G - full, S - selective gold

* Insulator color / shell plating:

D - Black/Tin, E - Black/Nickel

* Contacts: 09, 15, 25, 37, 50