

Recommended P.C.B Layout

Materials

Insulator : PBT, UL 94V-0

Contact : Brass

Specification

Current rating : 3 Amp

Insulation resistance : 5,000M Ω min.

Contact resistance : 20m Ω max.

Withstanding voltage: AC 500V for 1 minute

Operating Temperature : - 40°C ~ + 105°C

Order Information

PH - 2 x XX S X

- * Contact plating
G - Full Gold, S - Selective
- * S - Straight
- * Poles - 02 ~ 40

1. For special lengths, put (B / C) for lengths required at end of P/N

Dimensions

Poles	Dim E	Poles	Dim E	Poles	Dim E	Poles	Dim E	Poles	Dim E
2	2.54	10	22.86	18	43.18	26	63.50	34	83.82
3	5.08	11	25.40	19	45.72	27	66.04	35	86.36
4	7.62	12	27.94	20	48.26	28	68.58	36	88.90
5	10.16	13	30.48	21	50.80	29	71.12	37	91.44
6	12.70	14	33.02	22	53.34	30	73.66	38	93.98
7	15.24	15	35.56	23	55.88	31	76.20	39	96.52
8	17.78	16	38.10	24	58.42	32	78.74	40	99.06
9	20.32	17	40.64	25	60.96	33	81.28		

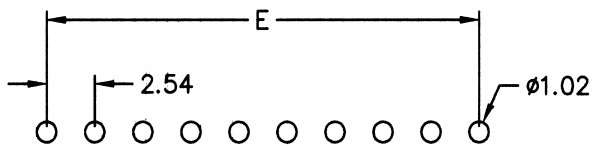
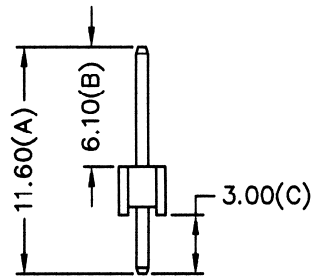
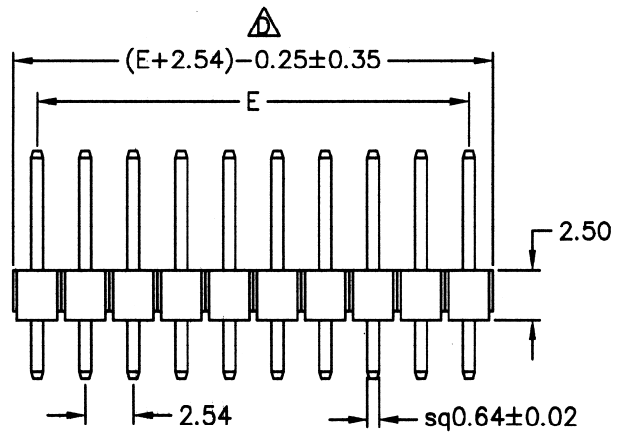
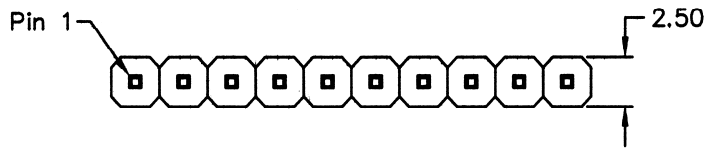

Recommended P.C.B Layout

Materials

Insulator : PBT, UL 94V-0

Contact : Brass

Specification

Current rating : 3 Amp

Insulation resistance : 5,000M Ω min.

Contact resistance : 20m Ω max.

Withstanding voltage: AC 500V for 1 minute

Operating Temperature : - 40°C ~ + 105°C

Order Information

PH - 1 x XX S X

- * Contact plating
G - Full Gold, S - Selective
- * S - Straight
- * Poles - 02 ~ 40

1. For special lengths, put (B / C) for lengths required at end of P/N

Dimensions

Poles	Dim E	Poles	Dim E	Poles	Dim E	Poles	Dim E	Poles	Dim E
2	2.54	10	22.86	18	43.18	26	63.50	34	83.82
3	5.08	11	25.40	19	45.72	27	66.04	35	86.36
4	7.62	12	27.94	20	48.26	28	68.58	36	88.90
5	10.16	13	30.48	21	50.80	29	71.12	37	91.44
6	12.70	14	33.02	22	53.34	30	73.66	38	93.98
7	15.24	15	35.56	23	55.88	31	76.20	39	96.52
8	17.78	16	38.10	24	58.42	32	78.74	40	99.06
9	20.32	17	40.64	25	60.96	33	81.28		